

The Excavation of the Bin House in Jamestown

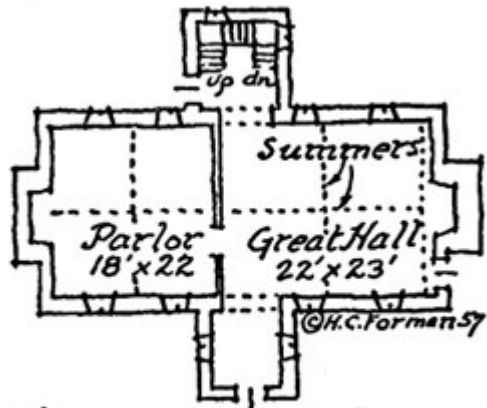

*A Cross Plan in Virginia
"Bacon's Castle," c. 1650*



bin houseparlor and great hall

The foundation of the "Bin House" at Jamestown, excavated by the National Park Service. The two brick bins have concave floors below the original main floor level. There were a number of dwellings, including spinning houses, smithies, tan houses, bin houses, well houses, hogsties, cornhouses, and guest houses. For the gardens, sometimes called "hortyards," there were summerhouses, greenhouses, and arbors.

Then there were bloomeries and ironworks, wharves for landing goods, called "bridges," warehouses, windmills, watermills, sawmills, glassworks, silkhouses, brick and pottery kilns, lime kilns, saltworks, and blockhouses.